

IMPORTANT NOTES

- 1) FINISH - PRE GALVANISED + ZINC PHOSPHATE + E COAT + UV POWDER COATING
- 2) ZINC-RICH EPOXY COATING (only for welding points)
- 2) COLOUR & TEXTURE - BLACK SAND
- 3) REMOVE SHARP EDGES & BURRS

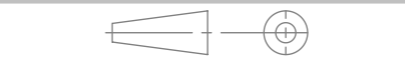

UNLESS OTHERWISE SPECIFIED
ALL DIMENSIONS ARE IN MILLIMETERS

	NAME	DATE	REVISION
DRAWN	GC	08/02/2018	F
CHECKED			

MATERIAL:
Mild Steel

FINISH:
Black Sand

GRIT SIZE:
N/A

WEIGHT: 20.61 Kg

NOTES:
Customer Drawing Information

DESCRIPTION:
Fixed Railing Panel Circles - 1016 x 2370mm - Black Sand

PART NO:
64FRC10B

DWG NO:
N/A

A3